

COMPONENTS OF ONIA

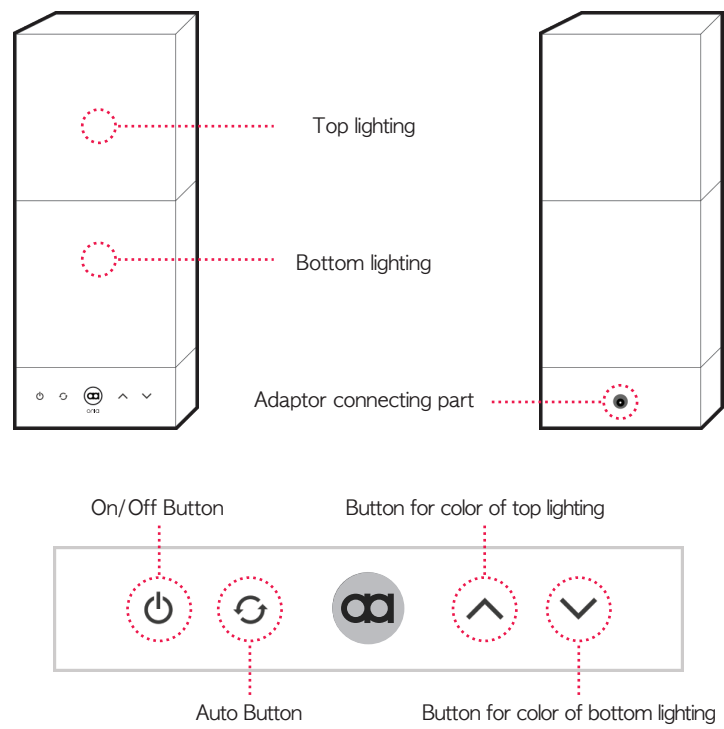

REGISTRATION

Activate the Bluetooth connection.
Start the ONIA Plus App to connect to your Onia.

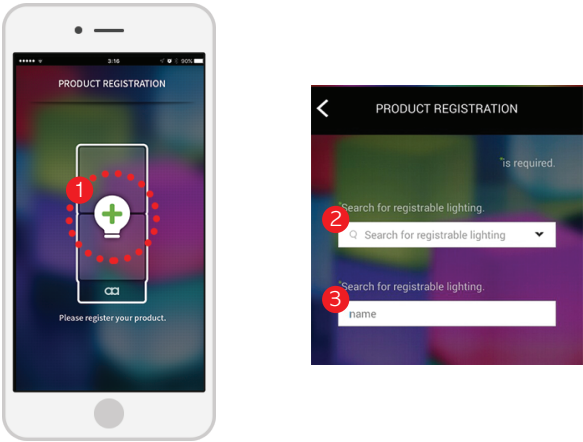

- 1 Register your Onia by touching + button (Add product).
- 2 Touch this area to search for your Onia.
- 3 If your Onia is set in the 2nd field, enter a name for the Onia here and then press the button "Add Onia".

USING ONIA

- On/Off Button
Plug the power adapter into the adapter connection and press the On/Off button to turn on the light.
- Auto Button
By pressing the AUTO button, the light-color of the upper and lower cube automatically changes.
- Button for color of top lighting
Color and brightness of lighting can be adjusted.
- Button for color of bottom lighting
Color and brightness of lighting can be adjusted.

Touch top/bottom color button softly to change color.
Press top/bottom color button for about 2 seconds to adjust the brightness in 5 levels.

ONIA APP FUNCTION



Find a detailed description of the app at: www.onia-light.com

- Manual color selection
The light-colors can be controlled directly via the app. At ONIACOLOR you can choose from 14 colors 196 different color combinations. At COLORPICKER you have the possibility to choose from 16 million colors.
- Mode
Life Mode (static) - useful colors for everyday life. Natural Mode (dynamic) - Color combinations from nature. Favorite Mode - here you can save your own color combinations.
- Today's Color
The last selected color-consulting appears.
- Setting
Here, the biorhythm is set by entering the date of birth
- Timer
The wake-up function automatically turns on the light at the set time, e.g. wake-up call service. The asleep function turns off the light at the set time.
- Fun
The light-color changes by shaking the smartphone.

ONIA APP DOWNLOAD

Download the app after searching for "ONIA Plus App" in the App Store or Google Play Store. Or scan the QR code to download the app.

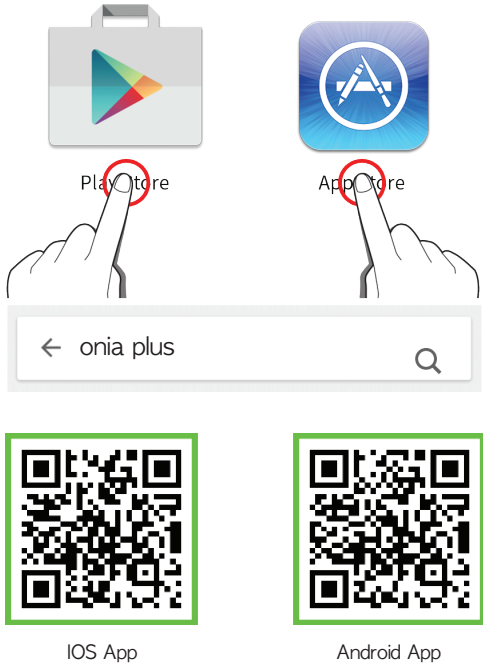

PRODUCT SPECIFICATION

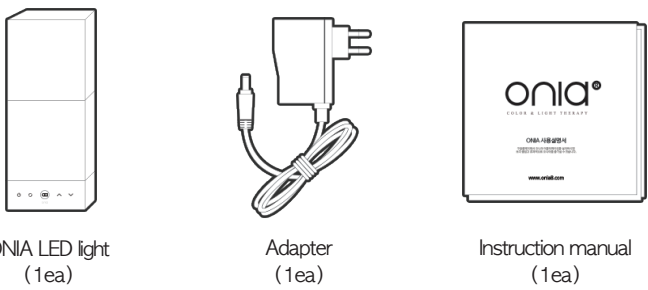

·Product Name	ONIA Home
·Product Size	140 x 140 x 380 (mm)
·Model Name.	Onia ver8
·Bluetooth Version	Bluetooth 4.1v
·Rated voltage	220V, 50/60Hz
·power consumption	12V, 1.0A
·Weight	1,3 kg